

# VENSKA

solidline

## EXTERIOR DOORS

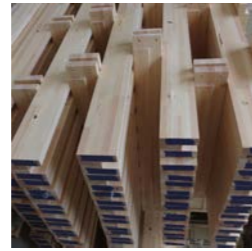



In order to give our customers product with good quality parametres and good price realtion we are focused on ope-rational excellence and production lexibility.



Just In time and perfect communication - to obtain these goals we give access to our order tracking platform so that customers can trace their orders and deliveries.



Solid - term that encompasses key values we strongly promote in our work: reliability, durability and trustworthiness. Underlined, give our brand a new meaning of



**Solidline.**

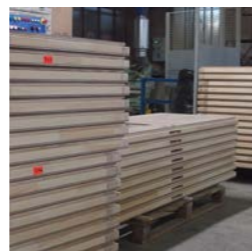
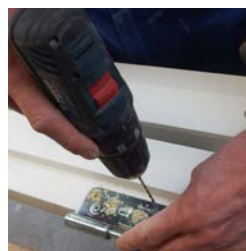
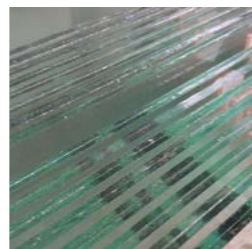

Y503



Y515



Y406



Y401



Y403



Y502



Y505



Y501



Y506



Y512



Y100



Y107



Y102



Y106



Y108



Y101



Y508



Y500



Y513



Y509



Y203



Y208



Y212



Y213



Y202





Y215



Y214



Y216



Y201



Y515



Y200



#### TECHNICAL DATA

standard door thickness **60/72**mm

frame 92/**105**mm

thermal insulation characteristics **U=0,85-0,98**

door frame strengthened with plywood

special waterproof fiberboard (HDF) on the surface

aluminium plate 0,4/**0,5**mm in the middle

thermal insulation EPS

additional moisture barrier at the bottom part of the door

2-layers surface treatment on each side

3 adjustable security hinges

**aluminium+oak** 25mm treshold